

**Features of Art Clay Exclusive Stencil Sheet**

1. Adheres well on curved surfaces (Note: only gentle curves are recommended).
2. Translucent quality so that base patterns can be seen through the sheet.
3. Waterproof, and more durable than ordinary stencil sheet, and keep the shape in a drying heat.
4. Delicate pattern designs not previously thought possible can be realized for the first time.

Possible variations of use for stencil sheet

- As a texture on a soft clay surface using roller.
- As a masking texture on a dry clay surface
- As a masking used for sandblasting.
- As a masking used for sulphurization./antique finishing
- As a porcelain and glass piece finishing technique



**Example for overlaying a dried Art Clay ring**

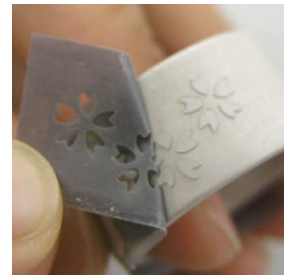

1. Stick the cut Stencil sheet on the surface of the ring.
2. Smear Art Clay Silver Paste type in the pattern with a spatula, and dry.
3. Apply a sponge sanding pad after drying the piece, and peel off the stencil sheet.

**Example for overlaying a glazed porcelain piece**

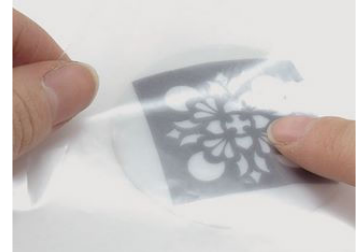
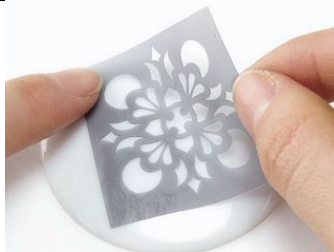

1. Cut out a pattern from the stencil sheet with craft knife.
2. Clean well the porcelain piece with a cleaning alcohol, and stick the cut pattern on the piece.
3. Place a plastic sheet (transparent is preferable) to avoid leaving grease, and rub to fix the stencil sticker on the piece.



4. Apply a sponging bar (I-124) in Art Clay Overlay Silver Paste.
5. Tap the sponging bar on the stencil sheet.
6. Dry the piece completely, and peel off the stencil sheet carefully.

<b>*Usage of 3 Art Clay Silver Paste Types*</b>		
<b>Paste type:</b>	<b>Overlay Silver Paste / Oil paste:</b>	<b>Overlay Silver Paste:</b>
Dried ACS piece	Fired ACS piece	Porcelain/Glass/Ceramic/Metal

**Please see more instructions on the back!**

# Relief Ring w/Stencil Sheet & Gemstones

## <Objective>

- Review on making perfect “Plate type” ring
- Understanding stone structure and setting in dried Art Clay without using bezel.
- Discovering of Art Clay Stencil Sheets, and its beautiful relief embellishment that can be done very easily. \*The Stencil sheets are exclusively designed for use with Art Clay Silver.



## <Tools & Materials>

ACS 650 Clay type 20g / Art Clay Exclusive Stencil Sheet / Synthetic Stones (2 φ) 10 pcs. / Basic Tools for making a ring with ACS/ Pin vise / Drill bit 2mm φ

## <Preparation>

Check your ring size, and consider shrinkage for making flat type ring. Wrap a self adhesive memo around the wooden mandrel.

1. Make a “Plate type” ring. Roll out ACS 650 20g clay in 3.5mm thick, and 2cm width.
2. Cut the clay in rectangle with Steel Scraper or a craft knife.
3. Set the clay on the self adhesive memo which wraps around the wooden mandrel, and cut the over wrapped Clay. Joint the ends with Paste type, and dry. Take out the ring out of mandrel, and trim the inside edge of the ring.
4. Stick the cut Stencil sheet on the surface of the ring.
5. Smear Paste type in the pattern with a spatula, and dry.
6. Mount the Paste type on the pattern until the paste go over the surface level of the Stencil sheet, and dry.
7. Do not peel off the Stencil sheet. Sand off the excess paste with sponge sanding pad (#320-600 grit)
8. Peel off the Stencil sheet very slowly.
9. Drill the hole of 2mm φ with drill bit and pin vise around the relief designs. Make sure to have girdle comes under the clay surface, table comes in same line with the clay surface.
10. If the table of stone is lower than clay surface, fill the bottom with Paste type, and adjust the depth. If the stone table is higher than clay surface, you need to drill the hole deeper to adjust.
11. Put a small amount of Paste type on the bottom of the hole, and place the stone. Fire the piece. Repeat the process to balance the stone positions.
12. Apply a stainless steel brush on the fired piece. Make the relief design (mounted part) in Mirror finish with a burnisher.

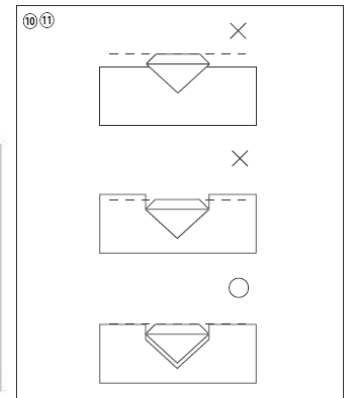
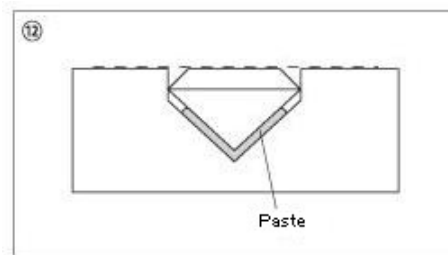
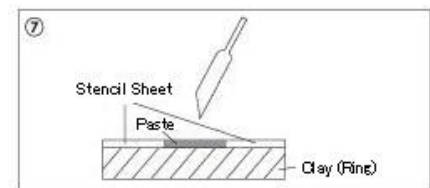
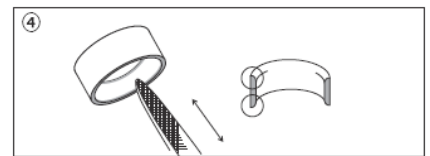
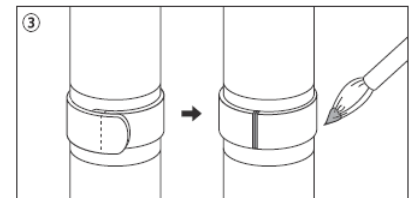

## History of Stencil sheet in Japan

Stenciling is one of the printing techniques which painted with cut patterns, letters, and shapes. We can see many techniques in the Japanese traditional hand crafts. Such as...

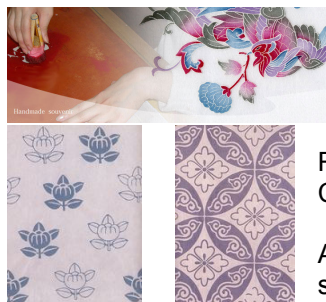

Left: “Bin Gata Zome (Dye) for Kimono dress” from Ryu Kyu (Okinawa; Southern Island of Japan)

Right top : “Yu Zen Zome” from Kyoto (Japan’s old capital)

Right bottom: “Kyo Kara Mi” developed in Kyoto, originally from China

All these traditional hand crafts express beautiful pattern by using stencil. Stenciling is simple and accurate which can print detailed pattern repeatedly which is hard to create by hand painting.

Manufacturer of Art Clay Silver : Aida Chemical Industries Co.,Ltd. Tokyo, Japan

For your local distributor’s information, please visit [www.artclay.co.jp](http://www.artclay.co.jp)

**ART CLAY** SILVER is a registered trademark around the world.